

Facility Type	DA #	Drainage Area Treated (Ft ²)	Impervious Area Treated (Ft ²)	Required PE (In)	Proportion of Target ESDv	Proportion of Target ESDv (Ft ³)	ESDv Provided (Ft ³)	Design PE (In)	Effective RCN
N-2 - Disconnection of Non-Rooftop Runoff	1	91,762	9,727	1.0	19%	1,112	1,112	1.0	64
N-2 - Disconnection of Non-Rooftop Runoff	2	194,583	622	1.0	15%	858	858	1.0	64
N-2 - Disconnection of Non-Rooftop Runoff	3	472,345	16,150	1.0	55%	3,180	3,180	1.0	64
N-2 - Disconnection of Non-Rooftop Runoff	4	91,995	15	1.0	7%	384	384	1.0	64
N-2 - Disconnection of Non-Rooftop Runoff	5	11,400	2,929	1.0	5%	267	267	1.0	64
Totals:		862,085	29,444	1.0	100%	5,801	5,801	1.0	64

Impervious Area Description	Length (FT)	Width (FT)	Area (SF)	Quantity	Total Area (SF)	Comments
Inverter/Equipment Pads (Concrete / Gravel)	20	8	160	2	320	Inverter Pad Site
Inverter/Equipment Pads (Concrete / Gravel)	Varies	Varies	1462	1	1,462	Equipment Pad Site
Solar Panels					154,085	Not Included in Total
Solar Panel Posts (W6x25)			0.05	2,390	122	Conceptual / Approximate
Entrance & Array Field Access Ways (Gravel / Asphalt)	Varies	18	27,540	1	27,540	Excludes Grass Access Ways, Includes Existing Driveway
Total Impervious Area					29,444	SF
					0.68	Acres

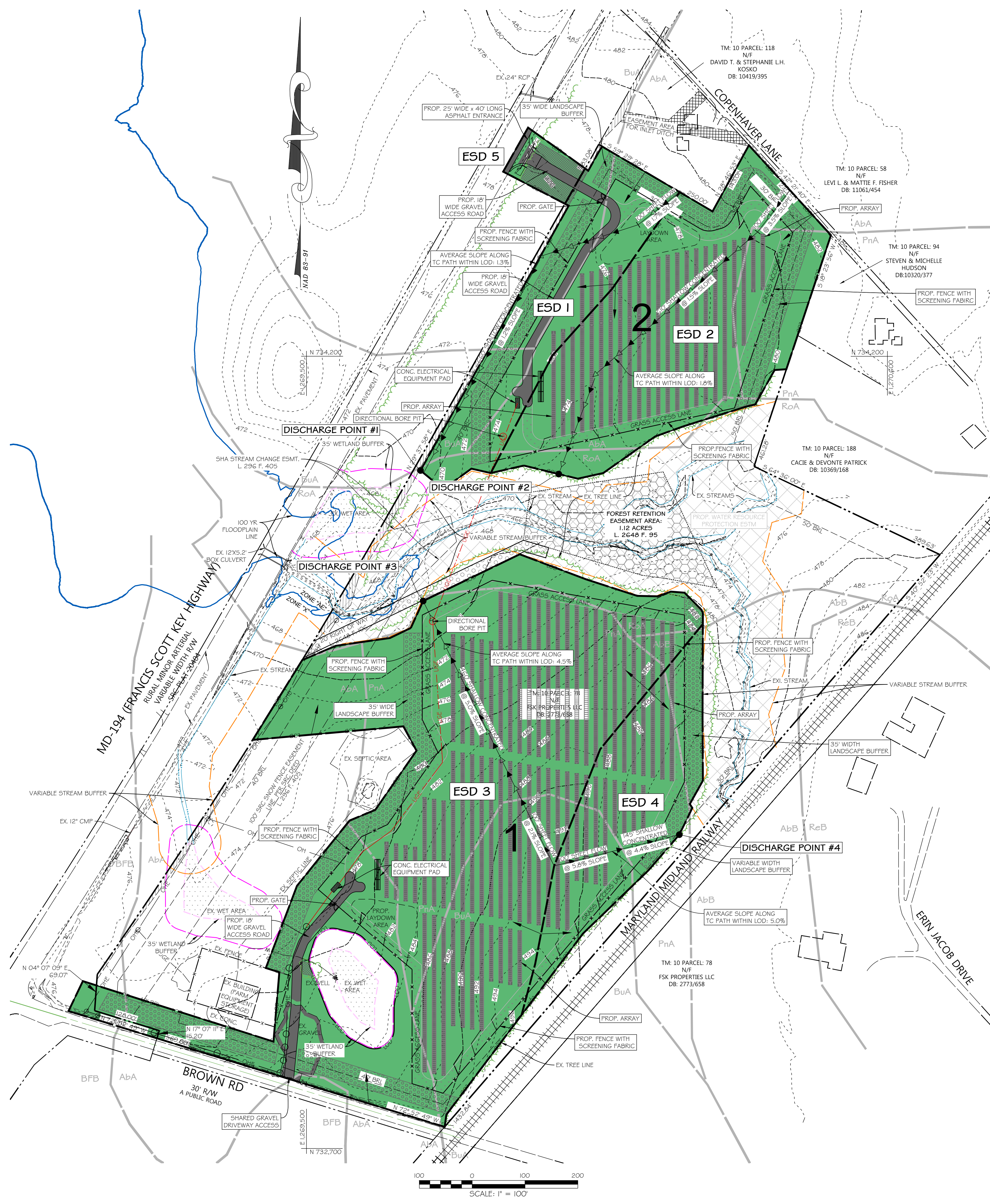

CALL "MISS UTILITY" AT 1-800-257-7777 FOR UTILITY LOCATIONS AT LEAST 5 DAYS PRIOR TO BEGINNING CONSTRUCTION.

PROFESSIONAL CERTIFICATION
 I HEREBY CERTIFY THAT THESE DOCUMENTS WERE PREPARED OR APPROVED BY ME, AND THAT I AM A DULY LICENSED PROFESSIONAL ENGINEER UNDER THE LAWS OF THE STATE OF MARYLAND, LICENSE NO. 42,429, EXPIRATION DATE: 06-06-2026

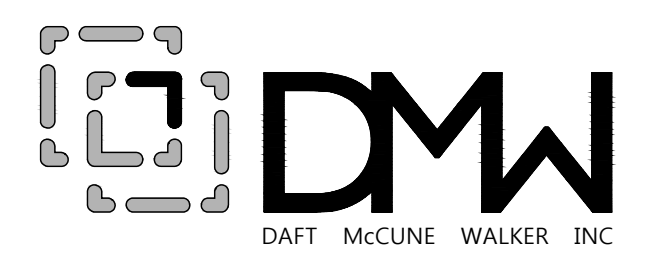

920 N. EAST STREET FREDERICK, MD 21701
 P: 301 696 9040 WWW.DMW.COM

**ESD DRAINAGE AREA MAP
 SWM CONCEPT PLAN**

**CONCEPT SITE
 DEVELOPMENT PLANS**
 for
BROWN ROAD SOLAR
 CARROLL COUNTY MD
 SHA TRACKING NO. 24APCLO13XX

OWNER
 F.S.K. PROPERTIES, LLC
 2217 RIDGE ROAD
 WESTMINSTER, MD 21157-7452
 443-929-6827

DEVELOPER
 4000 BROWN, LLC
 c/o PIVOT ENERGY - JOHN SHIELDS
 6665 DEERPATH ROAD, SUITE 330
 ELKRIE, MD 21075
 585-615-5765

DATE	BY	REVISIONS

- LEGEND:**
- LOD
 - LIMITS OF DISTURBANCE
 - PROPERTY LINE
 - FLOODPLAIN
 - STREAM
 - VARIABLE WIDTH STREAM BUFFER
 - 100' TOP OF STREAM BANK OFFSET
 - EX. TREE LINE
 - PROP. DRAINAGE AREA
 - EX. # PROP. TC PATHS
 - WETLAND # BUFFER
 - GRASSMEADOW WITHIN LOD
 - PROP. IMPERVIOUS AREA WITHIN LOD
 - PROP. LANDSCAPE BUFFER
 - PROPOSED WATER RESOURCE PROTECTION EASEMENT
 - TREE CLEARING AREA (±0.05 AC.)
 - TREE TRIMMING AREA (±0.02 AC.)

SEAL

INITIAL SUB: 03/20/2026
 SCALE: 1" = 100'
 DRAWN: JNS
 DESIGNED: JHV
 CHECKED BY: DSM
 PROJECT NO.: 23711
 DRAWING: 7 of 14