

© SITE RESOURCES, INC. 2/20/2014 11:52 AM 20140204.12 AM .dwg

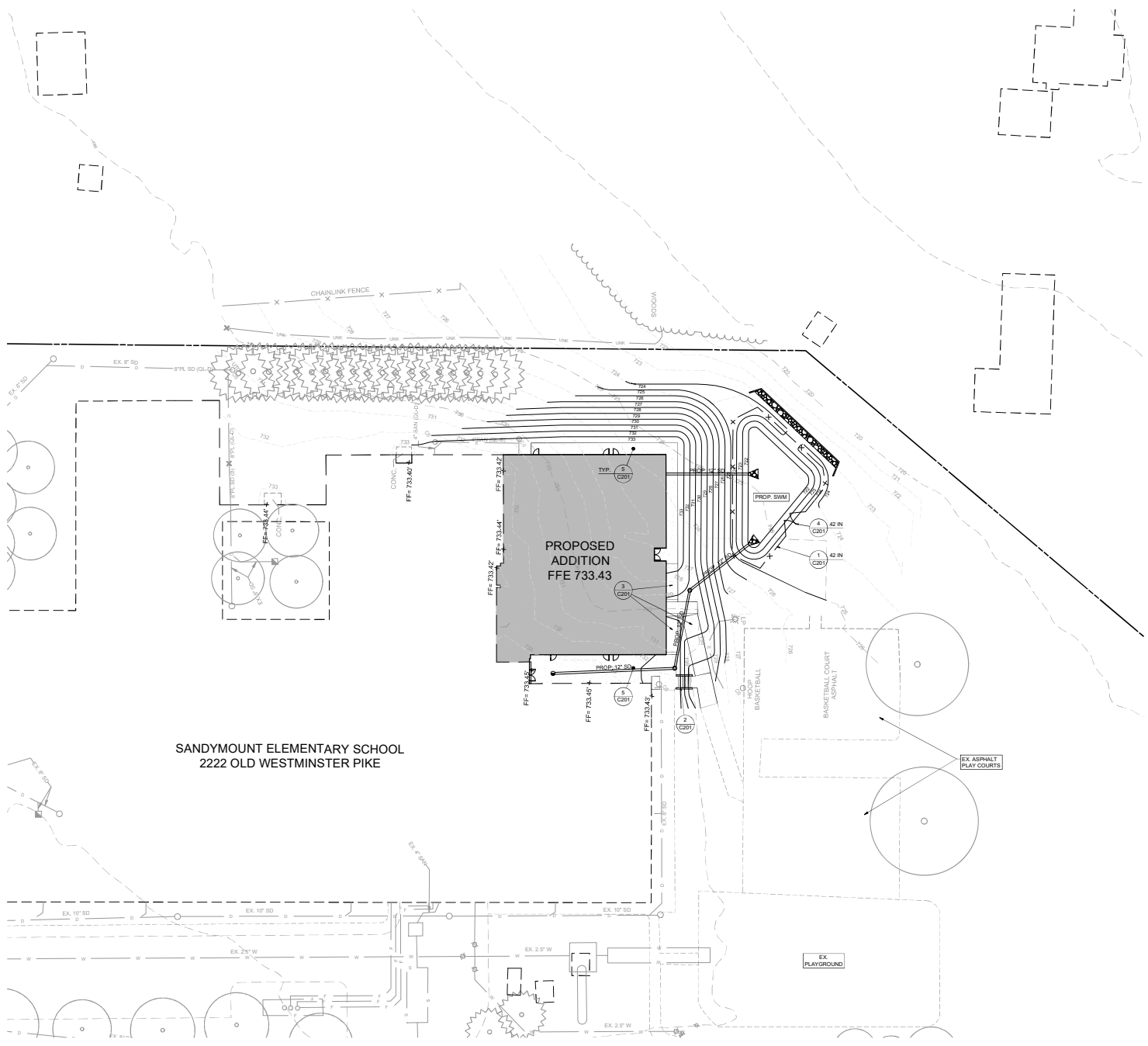

SANDYMOUNT ELEMENTARY SCHOOL  
2222 OLD WESTMINSTER PIKE

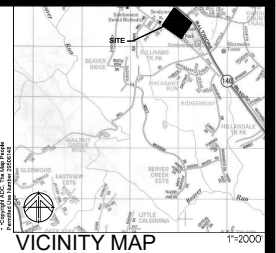

**LEGEND**

	PROPERTY LINE
	EXISTING BUILDING
	EXISTING WALK
	EXISTING ROAD
	EXISTING CURB
	EXISTING FENCE
	EXISTING TREES
	EXISTING SHRUBS
	EXISTING STORM DRAIN
	EXISTING WATER
	EXISTING SANITARY SEWER
	EXISTING GAS
	EXISTING FUEL OIL
	EXISTING TELEPHONE
	EXISTING ELECTRIC
	EXISTING OVERHEAD ELECTRIC
	EXISTING LIGHTING
	EXISTING CONTOURS
	PROPOSED BUILDING
	PROPOSED BUILDING OVERHANG
	PROPOSED SIDEWALK
	PROPOSED STORM DRAIN
	PROPOSED CONTOURS

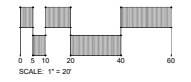

**MOSELEYARCHITECTS**  
1414 KEY HIGHWAY, SECOND FLOOR, BALTIMORE, MD 21202  
PHONE (410) 334-3300 FAX (410) 334-9955  
MOSELEYARCHITECTS.COM

**PROGRESS  
PRINT NOT FOR  
CONSTRUCTION**

**SITERESOURCES**  
Civil, Survey, Landscape & Engineering  
410.263.3288 www.siteresources.com

**SANDYMOUNT ELEMENTARY SCHOOL PRE-K & KINDERGARTEN ADDITION**  
CARROLL COUNTY PUBLIC SCHOOLS  
2222 OLD WESTMINSTER PIKE, FINKSBURG, MD 21048

PROJECT NO.	63136
DATE	REVISIONS
DATE	DESCRIPTION

**SITE PLAN**  
**C111**  
SHEET 4 OF 10

COUNTY FILE NUMBER  
4-23-2012