

MARYLAND STATE PLANE
NAD 83/2011 - NAVD 88

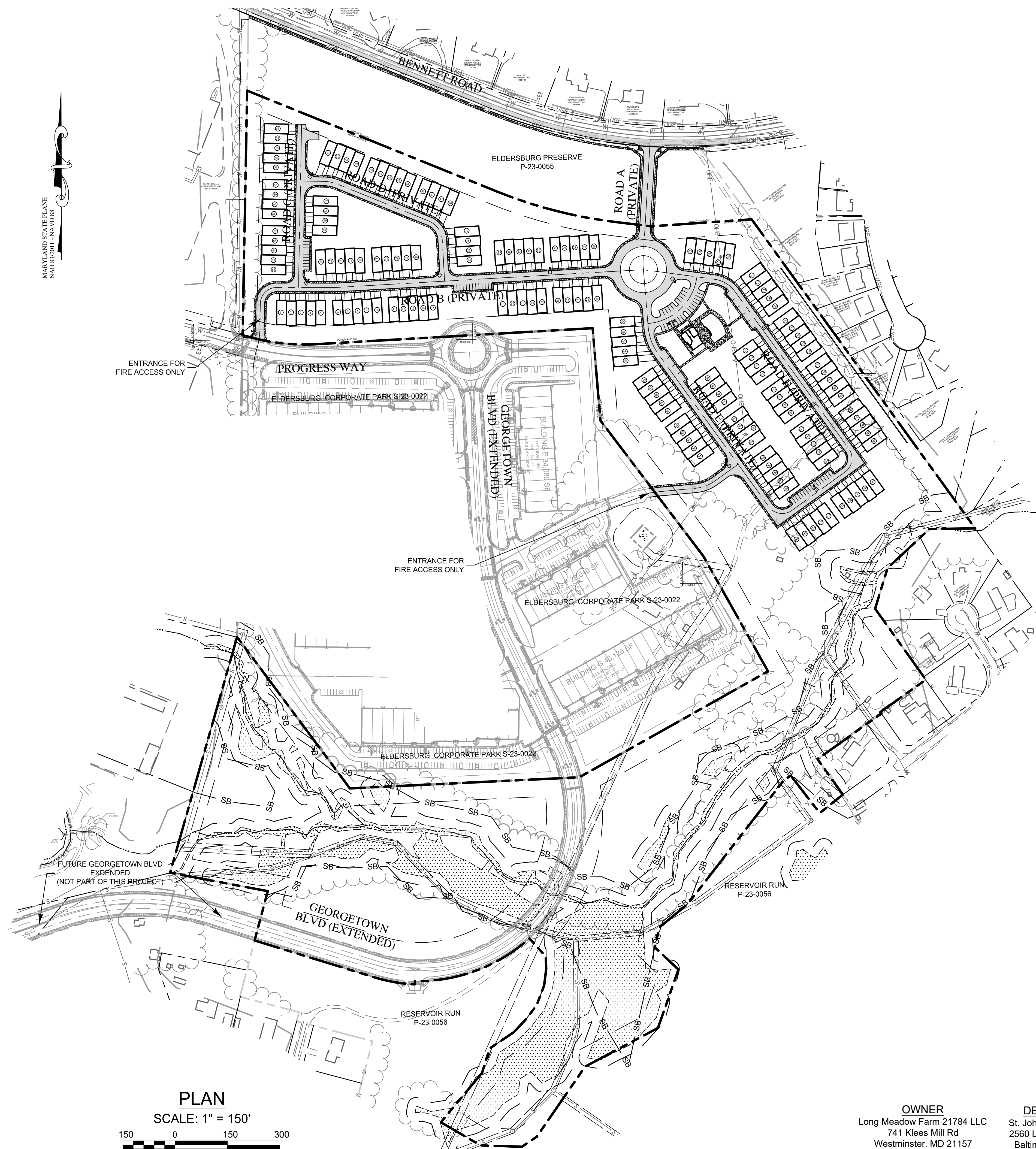

NOTES:
1. See Sheet 2 for Legends and Abbreviations.

- DATA SOURCES**
- EXISTING TOPOGRAPHY AND STRUCTURES SHOWN HEREON OUTSIDE OF THE LIMITS OF FIELD RUN TOPOGRAPHY ARE FROM CARROLL COUNTY GIS.
 - EXISTING TOPOGRAPHY FROM FIELD RUN SURVEY BY MTPLS LAND SURVEYORS, LLC, DATED NOVEMBER 2021.
 - BOUNDARY INFORMATION SHOWN HEREON IS FROM FIELD LOCATION PERFORMED BY MTPLS LAND SURVEYORS, LLC, NOVEMBER, 2021.
 - COORDINATES, BEARINGS AND DISTANCES SHOWN HEREON ARE REFERRED TO THE MARYLAND STATE COORDINATE SYSTEM (NAD 83/2011, NAVD 88)
 - DOWNSTREAM CONDITIONS TAKEN FROM THE "OAK CREEK FLOODPLAIN STUDY" DATED SEPT 2009.

CENTURY ENGINEERING
A Kleinfelder Company
10710 Gilroy Road, Hunt Valley, MD 21031
Phone: 443.589.2400 www.centuryeng.com

CONCEPT SITE DEVELOPMENT PLAN
OVERALL SITE PLAN
ELDERSBURG OVERLOOK
A RETIREMENT VILLAGE
Bennett Road
Eldersburg, MD
Tax Map 73 : Grid 6 : Parcel 246
Election District 5 Carroll County, MD

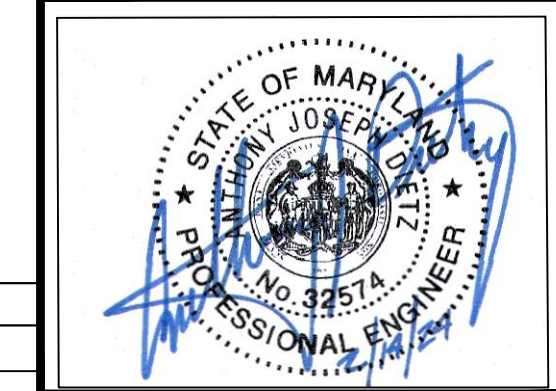

PROFESSIONAL CERTIFICATION
I HEREBY CERTIFY THAT THESE DOCUMENTS WERE PREPARED OR APPROVED BY ME, AND THAT I AM A DULY LICENSED PROFESSIONAL ENGINEER UNDER THE LAWS OF THE STATE OF MARYLAND.
LICENSE NUMBER: 32574
EXPIRATION DATE: 1/18/2026

PLAN
SCALE: 1" = 150'
150 0 150 300
SCALE: 1"=150'

OWNER
Long Meadow Farm 21784 LLC
741 Klees Mill Rd
Westminster, MD 21157
Phone No: 410-369-1207

DEVELOPER
St. John Properties, Inc.
2560 Lord Baltimore Rd
Baltimore, MD 21244
Contact: Matt Taylor
Phone No: 410-369-1207

DATE	BY	REVISIONS

S-23-0027

T:\2021\Facilities\02.11253.001A Beatty Property\CIVIL\CADD\Drawings\Concept 55 - Condes\211253.00 (C-1) Concept Overall Plan.dwg Apr 02, 2024 4:34pm rlangrehr